

## 1641 Avex

Large flange head · Aluminium body · Steel stem · Multi-grip  
3.2 mm (1/8") - 4.8 mm (3/16")

### Features

- Multi-grip capability accommodates wide variations in material thickness
- Good hole fill provides strong, vibration resistant joints
- Compensates for irregular, oversized, slotted or misaligned holes
- Can stop sheet movement in non-standard holes
- Retained stem avoids damage, electrical problems or rattling caused by loose stems
- Provides a large blind side bearing area against the rear sheet
- Spreads the tail bearing load/clamp load on the rear sheet making it ideal for use in thin sheet materials

### Material

- Body: Aluminium alloy (2.5% Mg) AA5052, natural
- Stem: Low carbon steel, zinc coated

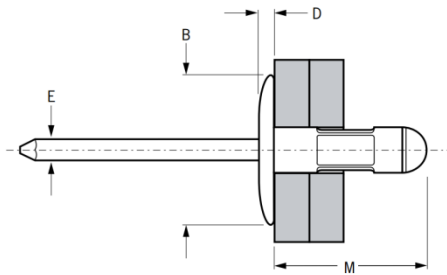

Before Placement

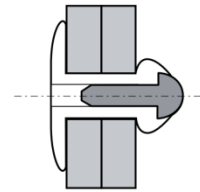

After Placement

Part No.	Size ø	Grip Range		Hole Size		M max.	øB max.	D max.	øE max.	Shear (typical) kN	Tension (typical) kN
		min.	max.	min.	max.						
01641-00410	3.2 (1/8")	0.8	4.8	3.3	3.4	10.5	8.6	1.2	1.9	0.73	1.02
01641-00412		1.6	6.4			12.0					
01641-00414		3.2	6.9			13.5					
01641-00416		4.8	9.5			15.0					
01641-00514	4.0 (5/32")	3.2	7.9	4.1	4.2	14.0	9.9	1.5	2.3	1.13	1.67
01641-00613	4.8 (3/16")	1.6	6.3	4.9	5.0	13.9	16.2	2.2	2.9	1.53	2.10
01641-00617		3.2	9.3			17.0				1.34	
01641-00619		4.8	11.1			18.7				1.34	
01641-00621		6.4	12.7			20.2				1.31	
01641-00631		12.7	19.8			28.2				1.42	



### Can't find what you are looking for?

We can provide customized finishing and colouring.  
Contact your nearest [Gripwell](#) team for assistance!